

## SIMPLEX ROLLER CHAINS WITH EXTENDED BARS

ČZ Standard

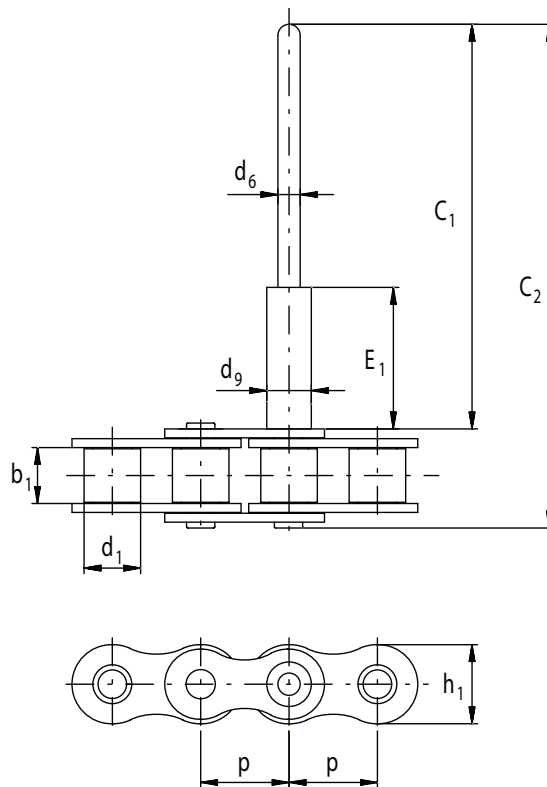

TRADE MARK ČZ	PITCH	INSIDE WIDTH	ROLLER DIAMETER	CONNECTING ELEMENT DIAMETER	BAR EXTENSION	CONNECTING LINK LENGTH	BAR EXTENSION	WHOLE LENGTH	INNER PLATE WIDTH
	p	b1 min.	d1 max.	d9	d6	E1	C1	C2	h2 max.
	mm	mm	mm	mm	mm	mm	mm	mm	mm
08 B-1	12,7	7,75	8,51	8,00	3,97	22,00	175,00	190,50	11,80
10 B-1	15,875	9,65	10,16	8,00	4,00	35,00	246,00	264,00	14,50
10 B-1	15,875	9,65	10,16	8,00	3,97	35,00	242,00	260,00	14,50
10 B-1	15,875	9,65	10,16	8,00	3,00	22,00	160,00	177,70	14,50
12 B-1	19,05	11,68	12,07	9,00	4,00	22,00	273,00	294,00	16,10
12 B-1	19,05	11,68	12,07	9,00	3,97	22,00	232,00	253,00	16,10
12 B-1	19,05	11,68	12,07	9,00	3,97	22,00	278,00	299,00	16,10

Bars position must be consulted with producer  
According to customer request a dural extender can be press on the bar end